

## MITO FOCUS

Gelato cabinets at fan ventilated refrigeration, double finned evaporator. One piece body with ecological polyurethane insulation (HCFC & HFC free), foamed with CO<sub>2</sub> 2.36 inch thick. Display base and service top in bright stainless steel, rear panel in carbon steel, powder painted, external base in painted sheet. Upper structure with silver-colored anodized aluminium supports. Tempered glasses. Front pyrolytic lift-up curved anti-fog glass with hydraulic pistons. Profile, complete light heading in silver-colored anodized aluminium; led lighting. Main structure and basement in carbon steel painted with epoxy powder, adjustable feet. Control board on the operator side, electronic board and digital thermometer inside the tank. Side panels with insulation and anti-scratch lacquering. Wheel kit for easy handling.



**ENERGY SAVING**  
Led + EC Fan motor



**INSTALLATION**  
Plug-in



**TEMPERATURE CONTROL**  
-4 / +35.6 °F



**DEFROST**  
Reverse cycle



**CLIMATIC CLASS**  
4 [86 °F / 55% R.H.]

### Standard model includes:

Operator side closure with pull-out methacrylate sliding doors



## MITO FOCUS

Model	Condensing unit included
	Air (STANDARD)
16	•
18	•
24	•

### Section

#### 16-18-24

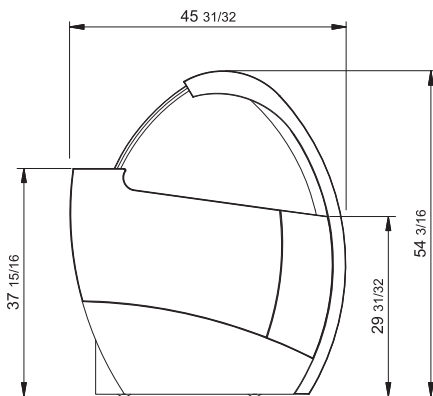

			18	18	24
External dimensions	LxDxH	inch	56 11/16 x 45 31/32 x 54 3/16	63 3/16 x 45 31/32 x 54 3/16	82 11/16 x 45 31/32 x 54 3/16
Capacity	Gross / Net	liters	932 / 239	-	1392 / 358
Net weight		lb	694	785	992
Refrigeration			Ventilated		
Refrigerant			R404A		
Climatic class			4		
Operating conditions		°F / %RH	86 / 55		
Cabinet capacity range		°F	-4 / +35.6		
Product temperature		°F	3.2 / 6.8		
Compressor	Type / Q.ty		Hermetic / 2		
Defrost			Reverse cycle		
Power supply		V / Hz / Ph	220 / 60 / 2 pole - 3 wire grounding		
Electrical input	Standard	A	11.8	11.8	12
	Defrost	A	17.9	17.9	18

In the interest of continual product improvements, ISA S.p.A. reserves the right to make changes in technical specifications and accessories at any moment and without prior notice

---

## MITO FOCUS

---

### Accessories

---

Grey cone holder

---

Scoop washer with water tap consolle LEFT/RIGHT

---

Kit labels flavours

---

Stainless steel tray V1 [2x2 5 liters] - V2 [2x3 5 liters]

---

## MITO FOCUS

### Packaging

### Nema plug

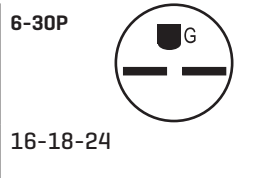

### Certifications



#### Carpigiani North America

3760 Industrial Drive  
Winston-Salem  
NC 27105

[www.carpigiani-usa.com](http://www.carpigiani-usa.com)



#### ISA S.p.A.

Via Madonna di campagna, 123  
06083 Bastia Umbra (PG)  
Italy

T. +39 075 801 71  
F. +39 075 800 09 00  
E. [customerservice@isaitaly.com](mailto:customerservice@isaitaly.com)

[www.isaitaly.com](http://www.isaitaly.com)

In the interest of continual product improvements, ISA S.p.A. reserves the right to make changes in technical specifications and accessories at any moment and without prior notice